

Elastic couplings with pins

PNMHP series, version with oversized hubs for high torques

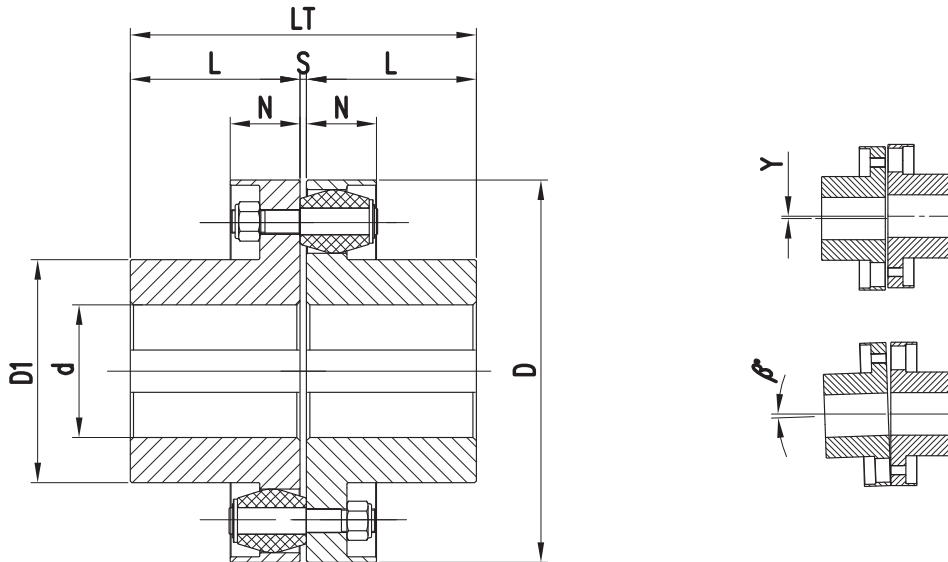

TYPE PNMHP	TECHNICAL DATA				DIMENSIONS (mm)							No. Pins	WEIGHT (kg)	MISALIGNMENT (±)	
	$\frac{N}{n} = \frac{kW}{rpm}$	Mt (Nm)	Max speed (rpm)	PD ² (kgm ²)	d _{max}	D	D1	L	N	$S \pm \frac{2}{0}$	LT			y(mm)	B(°)
90	0,0346	330	10600	0,0068	35	90	49	45	17	3	93	12	1,95	0,2	1°
100	0,0471	450	9500	0,0126	40	100	59	50			103	14	2,8		
112	0,0691	660	8500	0,0231	50	112	70	55			113	18	4,2		
125	0,0921	880	7680	0,0343	50	125	70	60	24	3	123	14	5,4		
140	0,115	1100	6800	0,071	60	140	85	70			143	16	8,2		
160	0,230	2200	6000	0,135	70	160	96	80	28	6	166	16	12,2		
180	0,304	2900	5300	0,268	80	180	116	90			186	18	18,5		
200	0,387	3700	4800	0,407	85	200	120	100	36	6	206	16	24		
225	0,492	4700	4260	0,784	105	225	144	110			226	18	35		
250	0,597	5700	3840	1,208	110	250	153	120	45	6	246	16	46		
280	0,764	7300	3400	1,868	130	280	183	130			266	18	63		
320	1,372	13100	3000	3,451	140	320	198	140	54	10	290	16	90		
360	1,801	17200	2700	5,626	170	360	240	160			330	18	125		
400	2,534	24200	2400	11,33	180	400	252	180	66	10	370	16	180		
450	3,298	31500	2160	21,71	215	450	302	200			410	18	270		
500	3,895	37200	1920	33,33	230	500	318	220	80	14	454	16	350		
560	4,921	47000	1740	52,87	260	560	360	240			494	18	465		
630	6,304	60200	1560	95,24	300	630	435	260	120	14	534	20	680		
710	12,70	121300	1400	160,1	320	710	442	280			574	14	940		
800	18,95	181000	1200	282	380	800	530	300	135	14	614	18	1340		
900	26,49	253000	1080	483	430	900	600	320			654	18	1870		
1000	32,67	312000	960	757	480	1000	660	350	135	14	714	20	2450		
1120	46,18	441000	900	1510	590	1120	830	380			774	24	3755		
1250	61,19	584400	800	2685	690	1250	960	420			854	28	5350		

The Weight and the PD² are calculated considering coupling with pilot bores.

For the machining of the finished bores it is necessary to specify diameters and keyways with tolerances.

On request is possible to have one or both hubs with different lengths.