

Elastic couplings with pins

PNM series, version with oversized hubs

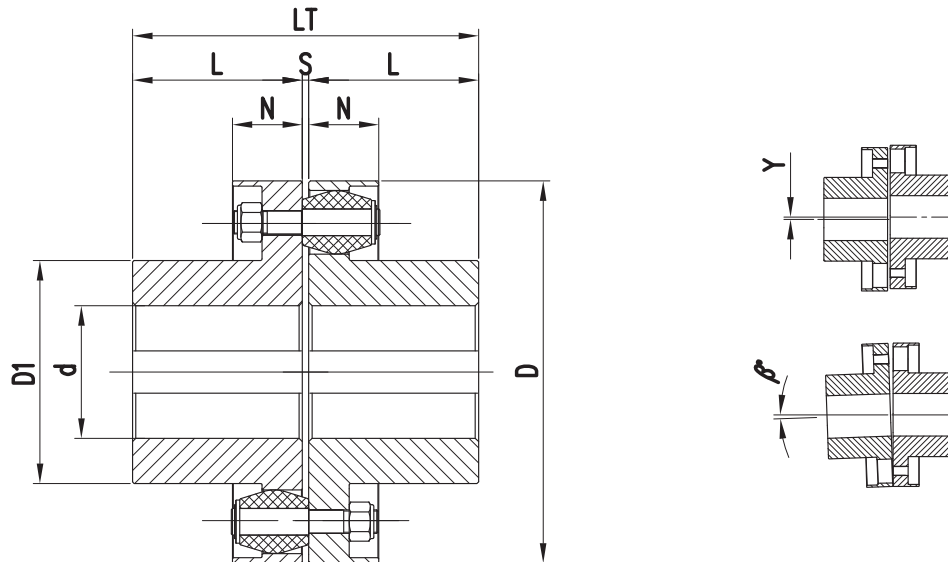

TYPE PNM	TECHNICAL DATA				DIMENSIONS (mm)							No. Pins	WEIGHT (kg)	MISALIGNMENT (±)	
	$\frac{N}{n} = \frac{\text{kW}}{\text{rpm}}$	Mt (Nm)	Max speed (rpm)	PD ² (kgm ²)	d max	D	D1	L	N	S ± ₀ ²	LT			y(mm)	β(°)
90	0,0230	220	10600	0,0068	35	90	49	45	17	3	93	12	1,95	0,2	
100	0,0314	300	9500	0,0126	40	100	59	50			103	14	2,8		
112	0,0461	440	8500	0,0231	50	112	70	55			113	18	4,2		
125	0,0618	590	7680	0,0343	50	125	70	60	24	3	123	14	5,4	0,4	
140	0,0817	780	6800	0,071	60	140	85	70			143	16	8,2		
160	0,154	1470	6000	0,135	70	160	96	80	28	6	166	16	12,2	0,4	
180	0,201	1920	5300	0,268	80	180	116	90			186	18	18,5		
200	0,257	2450	4800	0,407	85	200	120	100	36	6	206	16	24	0,4	
225	0,332	3170	4260	0,784	105	225	144	110			226	18	35		
250	0,398	3800	3840	1,208	110	250	153	120	45	6	246	16	46	0,4	
280	0,513	4900	3400	1,868	130	280	183	130			266	18	63		
320	0,912	8800	3000	3,451	140	320	198	140	54	10	290	16	90	0,8	1°
360	1,204	11500	2700	5,626	170	360	240	160			330	18	125		
400	1,696	16200	2400	11,33	180	400	252	180	66	10	370	16	180	0,8	
450	2,199	21000	2160	21,71	215	450	302	200			410	18	270		
500	2,597	24800	1920	33,33	230	500	318	220	80	14	454	16	350	0,8	
560	3,267	31200	1740	52,87	260	560	360	240			494	18	465		
630	4,20	40100	1560	95,24	300	630	435	260	120	14	534	20	680	0,8	
710	8,482	81000	1400	160,1	320	710	442	280			574	14	940		
800	12,67	121000	1200	282	380	800	530	300	135	14	614	18	1340	1,2	
900	17,70	169000	1080	483	430	900	600	320			654	18	1870		
1000	21,78	208000	960	757	480	1000	660	350	135	14	714	20	2450	1,2	
1120	30,78	294000	900	1510	590	1120	830	380			774	24	3755		
1250	40,79	389600	800	2685	690	1250	960	420			854	28	5350		

The Weight and the PD² are calculated considering coupling with pilot bores.

For the machining of the finished bores it is necessary to specify diameters and keyways with tolerances.

On request is possible to have one or both hubs with different lengths.